

THE GALLERY

sarasota

THE LUXURIOUS PENTHOUSE COLLECTION.

The Gallery Sarasota

6 Levels | 60 Residences | 5 Collections

Starting Under \$1M to \$2M

thegallerysarasota.com



The Penthouse Designer Integrated Kitchen





The Luxurious Penthouse Collection

(1) AVAILABLE AT THIS PRICE

PENTHOUSE 501-A

Offered at \$1,575,000 (\$902 PSF)	1,747 Living SF
3 Bedrooms	217 Terrace SF
3.5 Bathrooms	1,964 Total SF
14'0 Living/Kitchen Ceiling Heights	\$874 Monthly Fee

Exclusive Features

- Picturesque Center Courtyard & City Views
- Floor-to-Ceiling Windows & Glass Doors Flood Interior with Natural Light
- No Interior Column Obstructions
- Corner Penthouse Residence
- Two Private Foyers with In-suite Coat & Storage Room
- 27' Grand Private Terrace with Glass Panel Railing
- All Owner & Guest Bedrooms have WIC's and Ensuite Bathrooms
- Bathroom Glass Shower Enclosures and Italian Floating Vanities
- Individual Front-Loading Washer & Dryer
- Designer Kitchen with Imported Italian Flat-Panel Cabinetry
- Quartz Countertops with Full-Height Backsplash
- 15'3 Island with Choice of One- or Two-Tiers
- Italian Fulgor Milano Stainless Steel Appliances
 - 36" Cabinet-Depth Refrigerator
 - 30" Induction Cooktop
 - 30" Wall Mount Hood
 - 30" Built-In Oven
 - 30" Built-in Speed Oven/Microwave
 - 24" Dishwasher

THE GALLERY'S PICTURESQUE CENTER COURTYARD



Alternative Private Foyer on Level 4

4TH STREET

The Gallery Disclaimer: ORAL REPRESENTATIONS CANNOT BE RELIED UPON AS CORRECTLY STATING REPRESENTATIONS OF THE DEVELOPER. FOR CORRECT REPRESENTATIONS, MAKE REFERENCE TO THIS BROCHURE AND TO THE DOCUMENTS REQUIRED BY SECTION 718.503, FLORIDA STATUTES, TO BE FURNISHED BY A DEVELOPER TO A BUYER OR LESSEE. All renderings are artist's concept. Floorplans as reflected are conceptual in nature, and as-built room dimensions may differ to do changes in the field or changed conditions arising during the construction process.



The Luxurious Penthouse Collection

(2) AVAILABLE AT THIS PRICE

PENTHOUSE 501-BCD

Offered at \$1,850,000 (\$969 PSF)	1,910 Living SF
3 Bedrooms	217 Terrace SF
3.5 Bathrooms	2,127 Total SF
14'0 Living/Kitchen Ceiling Heights	\$955 Monthly Fee

Exclusive Features

- Picturesque Center Courtyard & City Views
- Floor-to-Ceiling Windows & Glass Doors Flood Interior with Natural Light
- No Interior Column Obstructions
- Corner Penthouse Residence with In-Suite Private Elevator
- Two Private Foyers with In-suite Coat & Storage Room
- 27' Grand Private Terrace with Glass Panel Railing
- All Owner & Guest Bedrooms have WIC's and Ensuite Bathrooms
- Bathroom Glass Shower Enclosures and Italian Floating Vanities
- Individual Front-Loading Washer & Dryer
- Designer Kitchen with Imported Italian Flat-Panel Cabinetry
- Quartz Countertops with Full-Height Backsplash
- 14'0 Island with Choice of One- or Two-Tiers
- Italian Fulgor Milano Stainless Steel Appliances
 - 36" Cabinet-Depth Refrigerator
 - 30" Induction Cooktop
 - 30" Wall Mount Hood
 - 30" Built-In Oven
 - 30" Built-in Speed Oven/Microwave
 - 24" Dishwasher

THE GALLERY'S PICTURESQUE CENTER COURTYARD



Alternative Private Foyer on Level 4

4TH STREET

The Gallery Disclaimer: ORAL REPRESENTATIONS CANNOT BE RELIED UPON AS CORRECTLY STATING REPRESENTATIONS OF THE DEVELOPER. FOR CORRECT REPRESENTATIONS, MAKE REFERENCE TO THIS BROCHURE AND TO THE DOCUMENTS REQUIRED BY SECTION 718.503, FLORIDA STATUTES, TO BE FURNISHED BY A DEVELOPER TO A BUYER OR LESSEE. All renderings are artist's concept. Floorplans as reflected are conceptual in nature, and as-built room dimensions may differ to do changes in the field or changed conditions arising during the construction process.



The Luxurious Penthouse Collection

(1) AVAILABLE AT THIS PRICE

PENTHOUSE 502-ABCD

Offered at \$1,575,000 (\$946 PSF)	1,665 Living SF
3 Bedrooms	217 Terrace SF
3.5 Bathrooms	1,882 Total SF
14'0 Living/Kitchen Ceiling Heights	\$833 Monthly Fee

Exclusive Features

- Picturesque Center Courtyard & City Views
- Floor-to-Ceiling Windows & Glass Doors Flood Interior with Natural Light
- No Interior Column Obstructions
- Corner Penthouse Residence with In-Suite Private Elevator
- Two Private Foyers with In-suite Coat & Storage Room
- 27' Grand Private Terrace with Glass Panel Railing
- All Owner & Guest Bedrooms have WIC's and Ensuite Bathrooms
- Bathroom Glass Shower Enclosures and Italian Floating Vanities
- Individual Front-Loading Washer & Dryer
- Designer Kitchen with Imported Italian Flat-Panel Cabinetry
- Quartz Countertops with Full-Height Backsplash
- 11'6 Island with Choice of One- or Two-Tiers
- Italian Fulgor Milano Stainless Steel Appliances
- 36" Cabinet-Depth Refrigerator
- 30" Induction Cooktop
- 30" Wall Mount Hood
- 30" Built-In Oven
- 30" Built-in Speed Oven/Microwave
- 24" Dishwasher

THE GALLERY'S PICTURESQUE CENTER COURTYARD

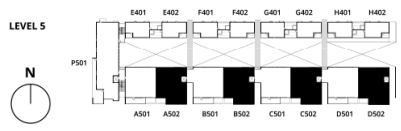
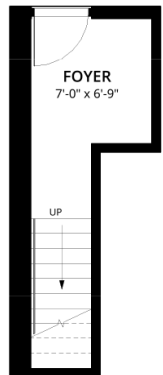

The Gallery Disclaimer: ORAL REPRESENTATIONS CANNOT BE RELIED UPON AS CORRECTLY STATING REPRESENTATIONS OF THE DEVELOPER. FOR CORRECT REPRESENTATIONS, MAKE REFERENCE TO THIS BROCHURE AND TO THE DOCUMENTS REQUIRED BY SECTION 718.503, FLORIDA STATUTES, TO BE FURNISHED BY A DEVELOPER TO A BUYER OR LESSEE. All renderings are artist's concept. Floorplans as reflected are conceptual in nature, and as-built room dimensions may differ to do changes in the field or changed conditions arising during the construction process.

4TH STREET

Alternative Private Foyer on Level 4

ITALIAN STAINLESS-STEEL APPLIANCES.

APPLIANCE PACKAGE THREE

FULGOR
MILANO



36" CABINET DEPTH
REFRIGERATOR FREEZER



24" DISHWASHER



30" WALL OVEN



30" BUILT-IN PRO SPEED OVEN



30" COOKTOP WALL HOOD



30" INDUCTION COOKTOP – 4 BURNER



Optional Upgrade – Add \$500
15" COOKTOP WALL HOOD



Optional Upgrade \$3,500
24" UNDERCOUNTER WINE COOLER



thegallerysarasota.com